

# AROMA®

## Water Heater & Dispenser Instruction Manual





With the Aroma® Water Heater & Dispenser, hot water is just a button press away. Boil up to 4 liters of water in just 30 minutes, then have it hot throughout the day.

The Aroma® Water Heater & Dispenser includes adjustable temperature settings which are great for a variety of needs.

With hot water available around the clock, quick preparation is ideal for all kinds of hot meals and beverages.

Including:

- Hot Tea
- Hot Chocolate
- Baby Formula
- Instant Coffee
- Instant Noodles
- Oatmeal

For more information on your Aroma® Water Heater & Dispenser or for additional kitchen solutions, visit us online at [www.AromaCo.com](http://www.AromaCo.com)



[AromaTestKitchen.com](http://AromaTestKitchen.com)



[/AromaHousewares](https://www.instagram.com/AromaHousewares)

Published By:  
Aroma Housewares Co.  
6469 Flanders Drive  
San Diego, CA 92121  
U.S.A.  
1-800-276-6286  
[www.AromaCo.com](http://www.AromaCo.com)

© 2017 Aroma Housewares Company All rights reserved.



# IMPORTANT SAFEGUARDS

*Basic safety precautions should always be followed when using electrical appliances, including the following:*

- 1. Read all instructions before use.**
2. Do not touch hot surfaces. Use handles or knobs.
3. To protect against electrical shock, do not immerse the cord, plug or the appliance in water or any other liquid.
4. Close supervision is necessary when this appliance is used by or near children. This appliance is not intended to be used by children.
5. Unplug from outlet when not in use and before cleaning. Allow to cool completely before putting on or taking off any parts, and before cleaning.
6. Do not operate this appliance with a damaged cord or plug or after the appliance malfunctions or has been damaged in any manner. Contact Aroma® customer service for examination, repair or adjustment.
7. The use of accessory attachments not recommended by Aroma® Housewares may result in fire, electric shock or injury.
8. Do not use outdoors.
9. Do not let the cord hang over the edge of a table or counter, or touch hot surfaces.
10. Do not place on or near a hot gas or electric burner, or in a heated oven.
11. Extreme caution must be used when moving the appliance containing hot water.
12. Always attach the plug to the appliance first, then plug the cord into the wall outlet. To disconnect, remove the plug from the wall outlet. Never pull on the cord.
13. Do not use this appliance for other than its intended use.
14. Never fill water beyond the FULL mark in the stainless steel water tank or below the MINIMUM mark on the water level indicator, otherwise it will boil over or damage the unit.
15. Do not open the lid when water is boiling. Hot steam may cause scalding.
16. Do not fill the Water Heater & Dispenser with any substance other than water.
17. Water in the Water Heater & Dispenser will be extremely hot. Use caution when serving as hot water may cause scalding. Always test temperature before serving.
18. If making baby formula with hot water, always add cold water as well. Water from the Water Heater & Dispenser will be too hot for the baby. The amount of cold water needed to reach an adequate temperature will vary. Always test the temperature before serving.
19. Use only on a level, dry and heat-resistant surface.
20. Do not touch, cover or obstruct the steam vent on the top of the Water Heater & Dispenser as it is extremely hot and may cause scalding.



# IMPORTANT SAFEGUARDS

## Short Cord Instructions

1. A short power-supply cord is provided to reduce the risks resulting from becoming entangled in or tripping over a longer cord.
2. Longer extension cords are available and may be used if care is exercised.
3. If a longer extension cord is used:
  - a. The marked electrical rating of the extension cord should be at least as great as the electrical rating of the appliance.
  - b. The longer cord should be arranged so that it will not drape over the counter top or tabletop where it can be pulled by children or tripped over unintentionally.
  - c. If the appliance is of the grounded type, the extension cord should be a grounding- type 3-wire cord.

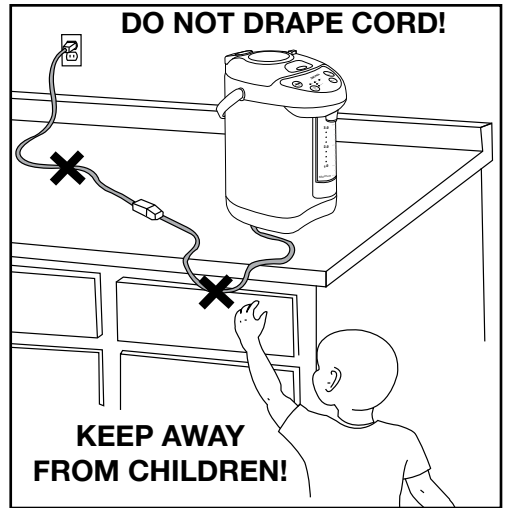

## Grounding Instructions

This appliance must be grounded while in use to protect the operator from electrical shock. The appliance is equipped with a 3-conductor cord and a 3-prong grounding-type plug to fit the proper grounding-type receptacle. The appliance has a plug that looks like sketch (A). An adapter, sketch (B), should be used for connecting sketch (A) plug plugs to two-plugs to two-prong receptacles. The grounding tab, which extends from the adapter, must be connected to a permanent ground such as a properly grounded outlet box as shown in sketch (C) using a metal screw.

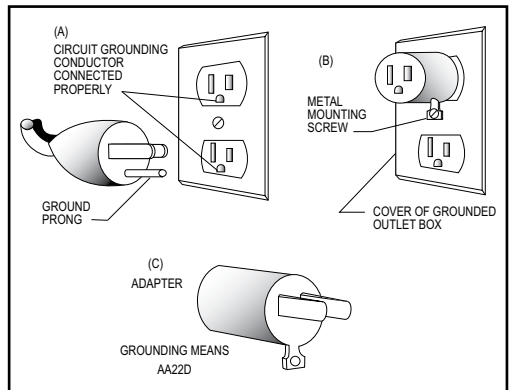



# PARTS IDENTIFICATION

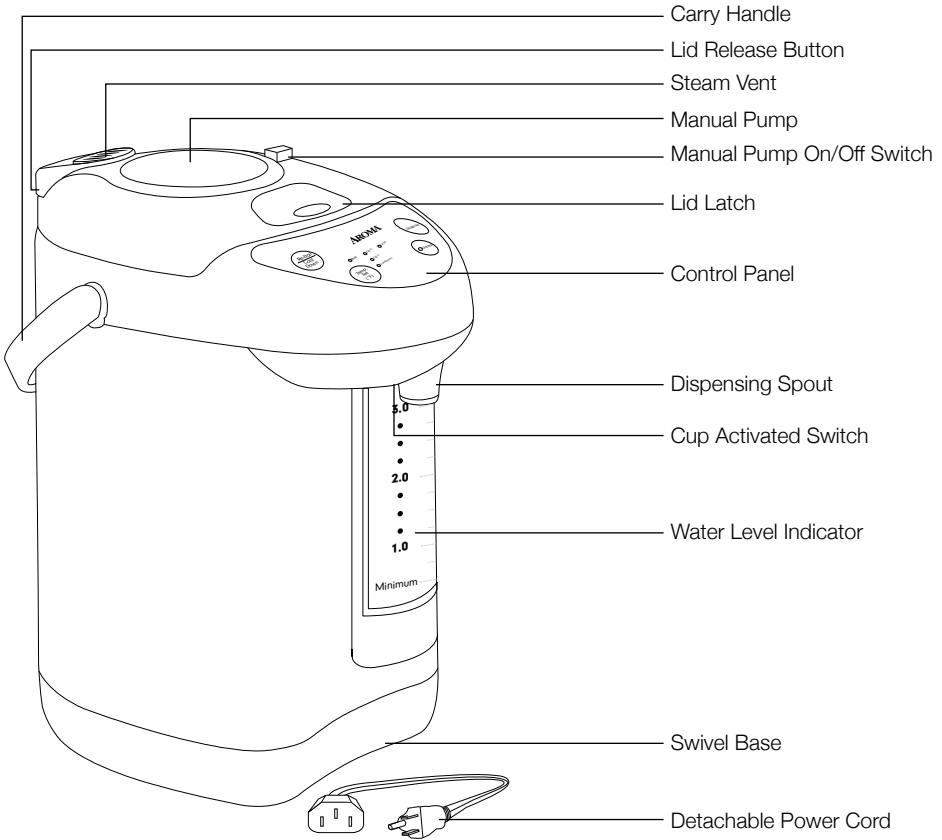

## CONTROL PANEL

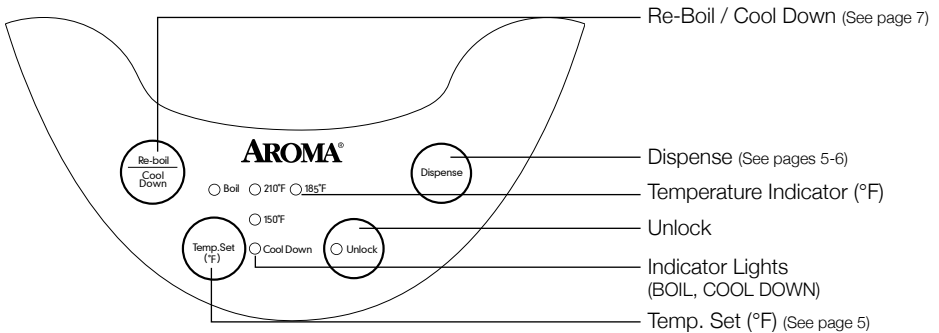



# BEFORE FIRST USE & HOW TO CLEAN

*Before using for the first time, it is recommended to clean the interior of the water dispenser thoroughly. Please follow the procedures below before using:*

**Always unplug the unit and allow it to cool completely before cleaning.**

1. Remove all packing materials and make sure that the product has been received in good condition.
2. Wash the stainless steel water tank with warm, soapy water using a sponge or dishcloth.
3. Rinse out the stainless steel water tank thoroughly to remove any soapy residue.
4. With a damp cloth, gently wipe off the exterior of the water dispenser. Do not wipe electrical components as this may cause damage to the unit.
5. Dry all parts completely.
6. **It is recommended to run your water dispenser through one boiling cycle before using it to consume beverages.** Following the instructions in TO HEAT WATER on **page 5**, boil a full tank of water. When water has boiled, pour it out and rinse the inside of the water tank once more. The water dispenser is now ready for use.

## REMOVING THE LID

*For easier cleaning and filling, the lid of the Digital Water Heater & Dispenser may be removed. To remove the lid:*

1. Press down on the lid release button (Figure A)
2. While holding down on the lid release button, open lid at a 45° angle and pull toward the front of the appliance. (Figure B)
3. To replace the lid, position it back into place while holding down the lid release button.
4. Once the lid is in place release the lid release button.

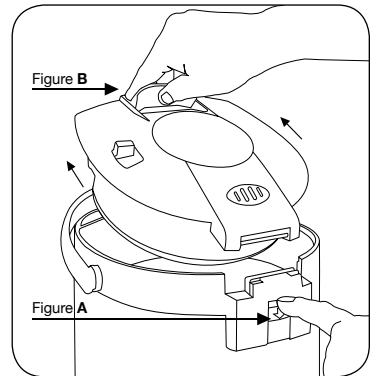

### NOTE

- Do not use abrasive cleaners or scouring pads.
- Do not immerse the appliance, cord or plug in water at any time.
- If you live in an area that has hard water, the stainless steel water tank may have limescale or mineral deposits over a long period of time. To remedy this, mix a solution of lemon juice and water, filling the stainless steel water tank up to the FULL mark. Boil water and let soak for one hour. Repeat cleaning instructions to remove any lemon juice residue.



# TO HEAT WATER

1. Lift the lid latch to open the lid. If needed, for filling purposes, the entire lid can be removed. See REMOVING THE LID on **page 4** for instructions.
2. Fill the stainless steel water tank with water anywhere between the FULL mark in the stainless steel water tank and the MINIMUM mark on the water level indicator. Properly replace the lid before heating water.
3. Attach the power cord by plugging the connector to the Water Heater & Dispenser and then connect the plug to an available 120V AC outlet.
4. The water will automatically begin heating and the BOIL indicator light will illuminate.
5. If a temperature is not selected, once the water has come to a boil it will default to 185°F (keep warm mode) and the 185°F light will illuminate. To select a different temperature, press TEMP SET (°F) to toggle between 150°F, 185°F and 210°F.
6. Once the water has come to a boil, the unit will automatically keep the water at the selected temperature. The BOIL indicator light will go off and the selected temperature indicator light will illuminate.
7. The Water Heater & Dispenser will keep the water warm at the selected warm temperature as long as it is plugged in, unless RE-BOIL/COOL DOWN is pressed.

## AUTOMATIC LOCKING FEATURE

1. For safety reasons, the Water Heater & Dispenser will automatically lock after each use. All dispense buttons/switches will be locked and water will not dispense.
2. To use the unit, press UNLOCK. The UNLOCK indicator light will illuminate and all dispense buttons will function properly.

## TO DISPENSE WATER

*For your convenience, there are three ways to dispense hot water from the Water Heater & Dispenser.*

### AUTOMATICALLY

1. Disable the automatic lock by pressing UNLOCK.
2. Press DISPENSE. Water will begin to pour. Water will continue to dispense as long as DISPENSE is pressed.
3. The Water Heater & Dispenser will automatically lock after 10 seconds after DISPENSE is released.



- **Never operate the Water Heater & Dispenser if the amount of water is below the MINIMUM line.**
- Never fill the stainless steel water tank past the FULL mark or below the MINIMUM mark on the water level indicator, otherwise it will boil over or cause damage to the unit.
- Do not open the lid while water is boiling. Hot steam may cause scalding.



## TO DISPENSE WATER (CONT.)

### MANUALLY

1. To dispense water with the MANUAL PUMP, move the MANUAL PUMP ON/OFF SWITCH on the top of the lid to the ON position.
2. Press down on the MANUAL PUMP. Pressing down will dispense water.
3. Repeat until the desired amount of water has been dispensed.

### CUP ACTIVATED SWITCH

1. Disable the automatic lock by pressing UNLOCK.
2. Press a heat-safe cup against the CUP ACTIVATED SWITCH located behind the dispensing spout.
3. Water will begin pouring once the switch is depressed.
4. To stop dispensing, simply remove the cup.
5. The Water Heater & Dispenser will automatically lock 10 seconds after the CUP ACTIVATED SWITCH is released.



**HELPFUL  
HINT**

- The manual pump option is great for serving, since no power is needed. Disconnect the cord and bring the Water Heater & Dispenser where it is needed.





# USING REBOIL/COOL DOWN

*Water may be reboiled at any time after the Water Heater & Dispenser has entered COOL DOWN.*

## TO REBOIL

1. Press REBOIL/COOL DOWN once. The Water Heater & Dispenser will begin to reboil the water and the BOIL indicator light will illuminate.
2. The warm temperature selection will remain at the previous level. To change the temperature, press TEMP SET (°F) to select desired temperature.
3. Once the water reaches a boil, the Water Heater & Dispenser will automatically switch back to your selected temperature. The BOIL indicator light will turn off and selected temperature (150°, 185°, or 210°) indicator light will illuminate.
4. The Water Heater & Dispenser will keep the water at the chosen temperature until the unit is unplugged or until REBOIL/COOL DOWN is pressed twice.

## TO COOL DOWN

1. Once the water has come to a boil and has switched to your selected temperature (150°, 185°, or 210°), press REBOIL/COOL DOWN twice. The selected temperature (150°, 185°, or 210°) indicator light will turn off and the COOL DOWN light indicator will illuminate.
2. While in COOL DOWN, the water temperature will slowly drop to room temperature until REBOIL/COOL DOWN is pressed.



- **Never operate the Water Heater & Dispenser if the amount of water is below the MINIMUM line.**
- Never fill the stainless steel water tank past the FULL mark or below the MINIMUM mark on the water level indicator, otherwise it will boil over or cause damage to the unit.
- Do not open the lid while water is boiling. Hot steam may cause scalding.







# LIMITED WARRANTY

## LIMITED WARRANTY

Aroma Housewares Company warrants this product against defects in material and workmanship for one year from provable date of purchase in the United States.

Within this warranty period, Aroma Housewares Company will repair or replace, at its discretion, defective parts at no charge, provided the product is returned, freight prepaid with proof of purchase and U.S. \$20.00 for shipping and handling charges payable to Aroma Housewares Company.

Before returning an item, please call the toll free number below for a return authorization number. Allow 2-4 weeks for return shipping. This warranty does not apply if the warranty period expired; the product has been modified by any unauthorized service center or personnel; the defect was subject to abuse, improper use not conforming to product manual instructions, or environment conditions more severe than those specified in the manual and specification, neglect of the owner or improper installation; the defect was subject to Force Majeure such as flood, lightning, earthquake, other natural calamities, war, vandalism, theft, brownouts or sags (damage due to low voltage disturbances).

This warranty gives you specific legal rights, which may vary from state to state, and does not cover areas outside the United States.

AROMA HOUSEWARES COMPANY  
6469 Flanders Drive  
San Diego, California 92121  
1-800-276-6286  
M-F, 8:30 AM - 4:30 PM, Pacific Time  
Website: [www.AromaCo.com](http://www.AromaCo.com)

## SERVICE & SUPPORT

In the event of a warranty claim, or if service is required for this product, please contact Aroma® customer service toll-free at:

1-800-276-6286  
M-F, 8:30AM-4:30PM, Pacific Time

Or we can be reached online at [CustomerService@AromaCo.com](mailto:CustomerService@AromaCo.com)

For your records, we recommend stapling your sales receipt to this page along with a written record of the following:

Date of Purchase: \_\_\_\_\_

Place of Purchase: \_\_\_\_\_



NOTE

- Proof of purchase is required for all warranty claims.