

## LIMITED WARRANTY

Aroma Housewares Company warrants this product free from defects in material and workmanship for one year from provable date of purchase in the continental United States.

Within this warranty period, Aroma Housewares Company will repair or replace, at its option, defective parts at no charge, provided the product is returned, freight prepaid with proof of purchase and U.S. \$8.00 for shipping and handling charges, payable to Aroma Housewares Company. Before returning an item, please call the toll free number below for a return authorization number. Allow 2-4 weeks for return shipping.

This warranty does not cover improper installation, misuse, abuse or neglect on the part of the owner. Warranty is also invalid in any case that the product is taken apart or serviced by an unauthorized service station.

This warranty gives you specific legal rights which may vary from state to state, and does not cover areas outside the United States.

AROMA HOUSEWARES COMPANY  
6469 Flanders Drive  
San Diego, California 92121  
1-800-276-6286  
M-F, 8:30 AM - 5:00 PM, Pacific Time  
Website: [www.aromaco.com](http://www.aromaco.com)

# AROMA<sup>®</sup>

## *21 Liter Convection Oven*



## Instruction Manual

*Model ABT-419DNS*

Congratulations!

Your **AROMA** 19-Liter Toaster Oven is one of the most versatile and unique appliances available. No other oven on the market offers more cooking options and usability. Your new oven can bake, convection bake, broil, dehydrate, defrost, toast and accommodates a 12" pizza. It will become the most utilized appliance in your home for preparing delicious meals quickly and easily. Please read the following instructions carefully before your first use.



Published By:

Aroma Housewares Co.  
6469 Flanders Drive  
San Diego, CA 92121  
U.S.A.  
1-800-276-6286  
www.aromaco.com

© 2005 Aroma Housewares Company All rights reserved.

## HOW TO USE

### 4. SETTING THE CLOCK

1. Press the "Clock" button and hold for 1 second. The display will show "Hr24" and "Clock" will flash continually.
2. If you would like to use 12 hour time, press the "Clock" button again. Display will show "Hr12". If you prefer 24 hour time, skip to (a).
  - a. Start off by setting the hour by pressing the increase or decrease button. The time will change for each press.
  - b. Press the "Clock" button again. Set the minutes by pressing the increase or decrease button.
  - c. Finally, press the "Clock" button one last time to confirm time.

### 5. USING THE PAUSE/CANCEL FUNCTION

Press the "Pause/Cancel" button once to pause. To restart, press the "Start" button once and the time will begin to count down again. Press the "Pause/Cancel" button twice to cancel cooking setting.

### 6. USING THE TIMER/TEMP. FUNCTION

Press the Timer/Temp. button once while the oven is in operation to display the time remaining. Press the same button again to display the temperature. The time remaining can also be adjusted mid-cycle.

## HOW TO CLEAN

*Always unplug unit and allow to cool before cleaning.*

1. Your oven features a non-stick interior coating for easier cleaning. If desired, wipe the walls with a damp sponge, cloth or nylon scouring pad and mild detergent.
2. Do not use abrasive scouring pads, abrasive cleaners or scrape interior with metal utensils. This could damage the non-stick interior coating.
3. Wash all accessories in hot soapy water or in the dishwasher.
4. Wipe the door clean with a damp sponge and wipe dry with a paper towel or cloth.
5. Clean exterior with damp sponge. Do not use an abrasive cleaner or steel wool scouring pad as it may damage the exterior finish.
6. Wipe baking trays and broiling pan with a damp sponge, cloth or nylon scouring pad. Do not use an abrasive cleaner or steel wool scouring pad as it may damage the porcelain enamel finish.
7. Empty crumb tray and wipe clean with damp cloth or sponge.
8. Always dry **ALL** parts and surfaces thoroughly prior to usage.

## HOW TO USE

### 2. USING THE DEHYDRATE FUNCTION

- a. Connect to power supply.
- b. Press the Dehydrate button to enter the dehydrate program.
- c. Press the time button. Set the time by pressing the increase or decrease button. The time will change for each press. Holding the button will cause the time to change rapidly.
- d. The temperature default is 185 degrees (temp. will not show in display).
- e. Open the door and place your food in the oven and press Start.
- f. When the program is complete, the unit will beep continually.
- g. Unplug the unit and allow it to cool completely before cleaning.
- h. To cancel during the cooking process press the Pause/Cancel button twice.

### 3. USING THE DEFROST FUNCTION

- a. Connect to power supply.
- b. Press the defrost button to enter the defrost program.
- c. Press the time button. Set the time by pressing the increase or decrease button. The timer will change for each press. Holding the button will cause the time to change rapidly.
- d. The temperature default is 150 degrees (the temp. will not show in the display).
- e. Open the door and place your food in the oven and press Start .
- f. When the program is complete, the unit will beep continually.
- g. Unplug the unit and allow it to cool completely before cleaning.
- h. To cancel during the cooking process press the Pause/Cancel button twice.

## IMPORTANT SAFEGUARDS

*Basic safety precautions should always be followed when using electrical appliances, including the following:*

1. Read all instructions before first use.
2. Do not touch hot surfaces. Use handles or knobs.
3. Close supervision is necessary when any appliance is used by or near children.
4. To protect against electric shock, do not immerse cord, plug, or any other parts of the oven in water or other liquids.
5. Do not let cord hang over the edge of tables and counters, or touch hot surfaces.
6. Do not operate appliance with damaged cord or plug or after the appliance malfunctions. If the oven has been damaged in any manner, return the appliance to the nearest Authorized Service Center for examination, repair or adjustment.
7. The use of accessory attachments not recommended by the appliance manufacturer may cause hazard or injury.
8. Do not place on or near a hot gas or electric burner, or in a heated oven or microwave oven.
9. When operating the oven, keep at least four inches of space on all sides to allow for adequate air circulation.
10. Unplug from outlet when not in use, or before cleaning. Let the unit cool completely before putting on or taking parts off, or before cleaning.
11. To disconnect, press the Stop/Cancel button twice, then unplug the plug. Always hold the plug. Never pull the cord.
12. Extreme caution must be used when moving an appliance containing hot oil or other hot liquids.
13. Do not cover the crumb tray or any part of the oven with foil. This may cause the oven to overheat.
14. Use extreme caution when removing crumb tray or disposing of hot grease or other hot liquids.
15. Do not clean with metal scouring pads. Pieces of the pad can break off and touch electrical parts, creating a risk of electric shock.
16. Oversized foods or metal utensils must not be inserted in a toaster oven as they may create a fire or risk of electric shock.
17. A fire may occur if the oven is covered or touching flammable material, including curtains, draperies, walls and things of the sort, while in operation. Do not store any item on top of the oven during operation.

## IMPORTANT SAFEGUARDS

18. Extreme caution should be exercised when using containers constructed of anything other than metal or glass inside the unit.
  19. Do not place any of the following materials in the oven: cardboard, plastic, paper or anything similar.
  20. Do not store any materials other than manufacturer's recommended accessories in this oven when not in use.
  21. Always wear protective, insulated oven mitts when inserting or removing items from the hot oven.
  22. This appliance uses a tempered, safety glass door. The glass is stronger than ordinary glass and more resistant to breakage. Tempered glass can break, but the pieces will not have sharp edges. Avoid scratching door surface or nicking edges. If the door has a scratch or chip, contact customer service before using the oven.
  23. Do not use outdoors.
  24. Do not use the appliance for anything other than its intended use.
  25. The temperature of the door and the outer surface will be hot when the appliance is working. Please exercise caution.
  26. Temperature of accessible surfaces will be high when the appliance is operating.
  27. Do not rest food on the tempered glass door at any time. It will not support the weight and can possibly be chipped or scratched.
- CAUTION:** Surfaces are hot during and after use. Always wear protective, insulated oven mitts when touching hot oven or hot dishes and food, or when inserting or removing racks, pans or baking dishes.

## SAVE THESE INSTRUCTIONS

## HOW TO USE

### C. Using the Fan Broil Function (Broil with Convection Heating)

- a. Connect to power supply.
- b. Press Oven button three times into the Fan Broil program.
- c. Press Time button. Set the time by pressing the increase or decrease button. The time will change for each press. Holding the button will cause the time to change rapidly.
- d. Press the TEMP button. The default temperature is 300 degrees (this can be adjusted). To change this temperature, press the increase or decrease button to move to the desired temperature. The temperature will increase or decrease in 50 degree increments.
- e. Place your food on the broil pan, and the broil pan on the bake pan. Open the door and slide the tray into the middle or top oven position depending on thickness of food. Close the door, press Start . The timer will begin its countdown.
- f. When the program is complete, the unit will beep continually.
- g. Unplug the unit and allow it to cool completely before cleaning.
- h. To cancel during the cooking process press the Pause/Cancel button twice.

**Note:** Foods that are irregular in shape, like fish or chicken breasts, take longer to cook in the thicker parts. To help them cook evenly, place the thickest parts to the outer rim of the food tray where they will receive more heat.

## HOW TO USE

### 1. USING THE OVEN FUNCTION:

#### A. Using the Bake Function

- a. Connect to power supply.
- b. Press the Oven button to activate the oven program. Press once for the bake function. The words "Oven Bake" should appear in the display window.
- c. Press Time button and set the time by pressing the increase or decrease button. The timer will change for each press. Holding the button will cause the time to change rapidly.
- d. Press the Temp. button. The default temperature is 300 degree (this can be adjusted). To change this temperature, press the increase or decrease button to move to the desired temperature. The temperature will increase or decrease in 50 degree increments until your desired level is reached. Maximum temperature is 400 degrees for the bake function.
- e. Open the door and place your food in the oven and press the Start button to begin.
- f. When the program is complete, the unit will beep continually.
- g. Unplug the unit and allow it to cool completely before cleaning.
- h. To cancel during the cooking process press the Pause/Cancel button twice.

#### B. Using the Fan Bake Function (Convection Heating)

- a. Connect to power supply.
- b. Press Oven button two times into the Fan Bake program. The words "Oven", "Fan" and "Bake" will appear in the display window.
- c. Press Time button. Set the time by pressing the increase or decrease button. The timer will change for each press. Holding the button will cause the time to change rapidly.
- d. Press the Temp button. The default temperature is 300 degrees (this can be adjusted). To change this temperature, press the increase or decrease buttons to move to the desired temperature. The temperature will increase or decrease in 50 degree increments. The maximum temperature is 400 degrees for the fan bake function.
- e. Open the door and place your food in the oven and press Start.
- f. To cancel during the cooking process press the Pause/Cancel button twice.

## SHORT CORD INSTRUCTION

1. A short power-supply cord is provided to reduce risks that result from becoming entangled in or tripping over a longer cord.
2. Longer extension cords are available and may be used if care is exercised in their use.
3. If a longer extension cord is used:
  - a. The marked electrical rating of the extension cord should be at least as great as the electrical rating of the appliance.
  - b. The longer cord should be arranged so that it will not drape over the counter top or tabletop where it can be pulled by children or tripped over unintentionally.

## POLARIZED PLUG

This appliance has a **polarized plug** (one blade is wider than the other); follow the instructions below:

To reduce the risk of electric shock, this plug is intended to fit into a polarized outlet only one way. If the plug does not fit fully into the outlet, reverse the plug. If it still does not fit, contact a qualified electrician. Do not attempt to modify the plug in any way.



**This appliance is for household use only.**



## PARTS IDENTIFICATION

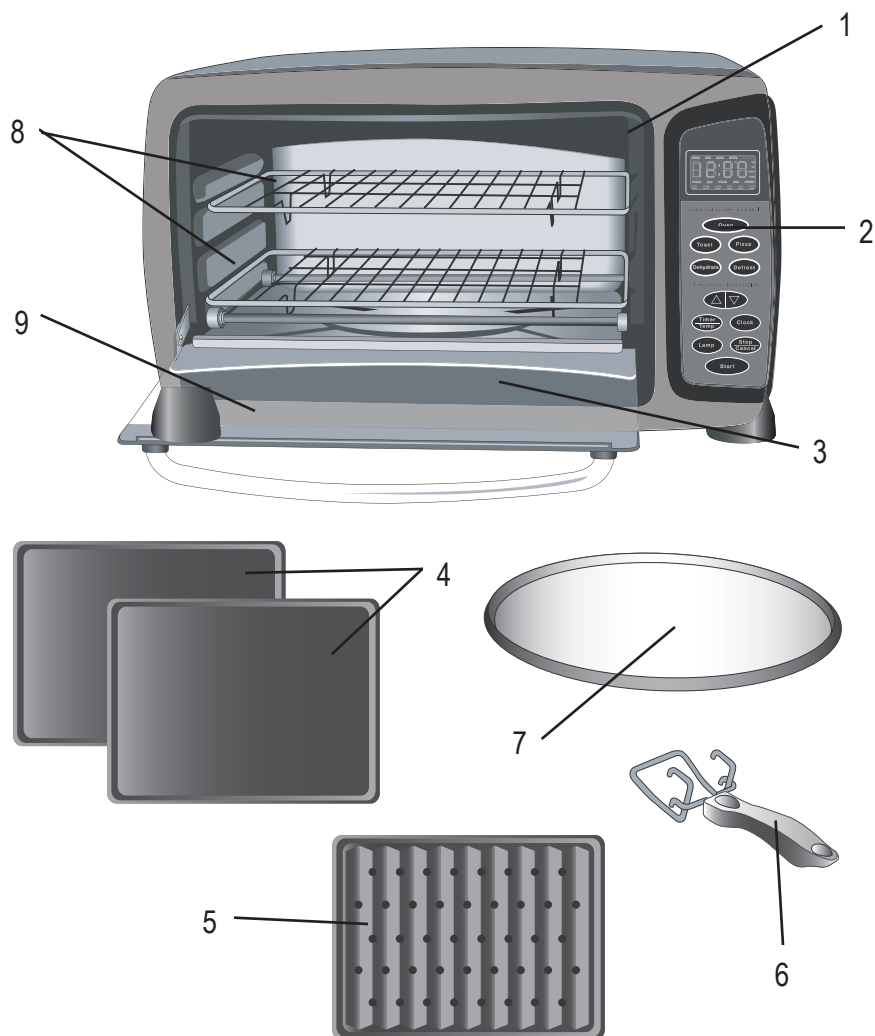

- |                         |                          |
|-------------------------|--------------------------|
| 1. Convection Fan       | 2. Digital Control Panel |
| 3. Removable Crumb Tray | 4. 2 Baking Pans         |
| 5. Broil Pan            | 6. Rack Handle           |
| 7. Pizza Pan            | 8. Baking Racks          |
| 9. Tempered Glass Door  |                          |

## HOW TO USE

### "b-12" Mode for 9" - 12" Pizza

- Connect to power supply.
- Press Pizza button twice and the display will show "b-12".
- This is the timer selector for a 9"-12" pizza. There is no darkness setting and temperature is set by default. Press the TIME/TEMP button and use the Adjustment Buttons to set your preferred cooking time.
- When the program is complete, the unit will beep ten seconds continually.
- Unplug the unit and allow it to cool completely before cleaning.

NOTE: ALWAYS REMOVE FOOD FROM OVEN WITH PROTECTIVE OVEN MITTS. OVEN, FOOD AND OVEN DOOR WILL BECOME VERY HOT WITH USE.

### Pizza Cooking Suggestions:

- Place a baking rack to the desired height. It is strongly recommended that the center rack be used for even cooking and browning results.  
\*\* When cooking a name brand frozen pizza for the first time, carefully monitor cooking process to get the desired results.
- Preheat the oven on the "Bake with Fan" function for 10 minutes at 400°F, then follow cooking instructions for pizza functions above.
- Crust type:
  - For a softer crust use the pizza pan supplied with your oven.
  - For a crispier crust, place the pizza directly on the oven rack.

NOTE: For homemade or dough crusts, you will need to use the pizza pan. There are two pizza settings on your oven, A-9 and b-12. Follow whichever directions above apply to your pizza size and preference.

# HOW TO USE

## Pizza Function:

### "A-9" Mode for 9"- 12" Pizza

- Connect to power supply.
- Press Pizza button once and the display will show "A-9".
- To select the desired Pizza browning press adjustment keys. The light default setting shows in the display window. Press the increase button to move to a darker setting. Press the decrease button to move to a lighter setting. Open the door and place your pizza in the oven and press Start . To cancel press the Pause/Cancel button twice.
- When the program is complete, the unit will beep continually.
- Unplug the unit and allow it to cool completely before cleaning.



9"-12" Pizza  
2 Red Squares  
Light Crust  
15-Minute Cooking  
Time



9"-12" Pizza  
4 Red Squares  
Medium Crust  
18-Minute Cooking  
Time



9"-12" Pizza  
6 Red Squares  
Dark Crust  
21-Minute Cooking  
Time

# HOW TO USE

## Before first use:

- Read all instructions and important safeguards.
- Unpack the toaster oven and remove all packaging materials.
- Check the contents against the accessories list.
- Remove all labels including the protective film on the control panel.
- Select a suitable position for the unit on a flat surface close to a power socket but far away from another heat producing appliance. Make sure there is at least 4" of space between the convection oven and kitchen walls.
- Plug into a suitable power outlet.

## Control Panel Operations:

- DISPLAY WINDOW** - Indicates program currently in use and time remaining until process is completed.
- OVEN FUNCTION** - Press once to select Bake, twice to select Fan Bake or three times to select Fan Broil.
  - Bake: Default temperature setting is at 300 degrees. Default time is 30 minutes. Maximum Time is 1 hour and 30 minutes. The lower heating element and upper square heating element are working during bake. Maximum temperature is 400 degrees.
  - Fan Bake: Default temperature setting is at 300 degrees. Default time is 30 minutes. Maximum Time is 1 hour and 30 minutes. The lower heating element and upper square heating element are working along with the convection fan. Maximum temperature is 400 degrees. (for more information on bake and fan bake see page 10)
  - Fan Broil: Fixed temperature setting is at 450 degrees. Default time is 30 minutes. Maximum Time is 1 hour 30 minutes. The lower heating element and upper square heating element are working along with the convection fan. Maximum temperature is 450 degrees. (for more information on fan broil see page 11)
- TOAST FUNCTION** - Use the Adjustment Buttons to select toast color. There are six levels to choose from, each making the toast progressively darker. (for more information on toasting see page 7)

## HOW TO USE

4. **PIZZA FUNCTION** - Press the Pizza button once and the display will show "A-9". This is the browning selector for a 9"-12" pizza. There are three levels to choose from. Use the Adjustment Buttons to set your browning control to light, medium or dark crust settings. (2 red squares for light, 4 red squares for medium and 6 red squares for dark) Press the Pizza button twice, and the display will show "b-12". This is the timer selector for a 9"-12" pizza. There is no darkness setting and temperature is set by default. Press the TIME/TEMP button and use the Adjustment Buttons to set your preferred cooking time. The back of the appliance is shaped specifically to accommodate a 12" pizza pan. (for more information on the pizza function see pages 8-9)
5. **DEHYDRATE** - Press to select dehydrate program. (for more information see page 12)
6. **DEFROST** - Press to select defrost program. (for more information see page 12)
7. **ADJUSTMENT BUTTONS** - Press to adjust temperature, time or to adjust color of the toast or any cooking that has multiple levels of baking or toasting.
8. **CLOCK** - Press to display the clock. Use the Adjustment Keys to adjust time. (for more information see page 13)
9. **LAMP** - Press to turn on the interior light. Press again to turn off.
10. **STOP/CANCEL** - Press once to pause the timer or press twice to cancel the cooking process. (Except for the toasting function. See page 7.
11. **START** - After selecting the function, temperature and time, press Start to begin the cooking process.

## HOW TO USE

### Toast Function:

1. Place a baking rack in the middle rack position and place the desired amount of toast on rack.
2. Press the "Toast" button:
  - Press "Toast" button once for up to two slices of bread (screen will display a number 2, representing two slices of bread.)
  - Press "Toast" button twice for four to six slices of bread (screen will display a number 4, representing four to six slices of bread.)
3. Note that under the number of toast selected (2 or 4) there will be three small red squares representing the level of toasting - light to dark. Oven is set by default to three squares, which represents "medium light" toast. Adjust with the up and down adjust arrows for desired toast darkness or lightness.
4. Press the start button and the timer will begin its countdown. To pause the program, press the PAUSE/CANCEL button once. To restart the program, press start. To cancel the program press and hold the PAUSE/CANCEL button for 2 seconds
5. When program is complete, the unit will beep continually.



Very light toast



Light toast



Medium light toast  
(default setting)



Medium toast



Medium dark toast



Dark toast

Toasting Chart

1 square	Very Light
2 squares	Light
3 squares	Medium Light
4 squares	Medium
5 squares	Medium Dark
6 squares	Dark