

# AROMA®

ACM-900GB

## Instruction Manual Grind & Brew Coffee Maker



**Questions or concerns  
about your coffee maker?**  
*Before returning to the store...*



Aroma's customer service  
experts are happy to help.  
Call us toll-free at  
**1-800-276-6286.**



Answers to many common  
questions and even replacement  
parts can be found online. Visit  
**[www.AromaCo.com/Support](http://www.AromaCo.com/Support).**





Congratulations on your purchase of the Aroma® 10-Cup Grind & Brew Coffee Maker!

Your Aroma® 10-Cup Grind & Brew Coffee Maker has a built-in grinder, allowing you to brew whole or pre-ground coffee beans for delicious home-brewed coffee. A programmable brew timer sets up to 24-hours for added kitchen convenience— simply add coffee beans or grounds the night before and have freshly brewed coffee ready the next morning. Once coffee finishes brewing an automatic keep-warm setting keeps coffee warm for up to 2 hours. And a pause and brew feature lets you pour a cup of coffee mid-brew—perfect for those rushed early mornings.

The durable permanent filter makes brewing cup after cup hassle-free, while cleaning is a breeze as all removable parts clean easily in the dishwasher!

For more information about your Aroma® 10-Cup Grind & Brew Coffee Maker, or for product service, replacement parts and other home appliance solutions, please visit us online at **[www.AromaCo.com](http://www.AromaCo.com)**.



**[www.AromaTestKitchen.com](http://www.AromaTestKitchen.com)**



**[www.facebook.com/AromaHousewares](http://www.facebook.com/AromaHousewares)**



**[www.twitter.com/AromaHousewares](http://www.twitter.com/AromaHousewares)**



Published By:  
Aroma Housewares Co.  
6469 Flanders Drive  
San Diego, CA 92121  
U.S.A.

1-800-276-6286

[www.AromaCo.com](http://www.AromaCo.com)

©2013 Aroma Housewares Company  
All rights reserved.





# IMPORTANT SAFEGUARDS

*Basic safety precautions should always be followed when using electrical appliances, including the following:*

**1. Important: Read all instructions before use.**

2. Do not touch hot surfaces. Use handles or knobs.
3. Do not remove the lid when the coffee maker is brewing. Scalding may occur if the lid is removed during the brewing cycle.
4. Never turn on the coffee maker when there is no water in the coffee maker as it may burn the product and cause permanent damage.
5. When filling with water, never exceed the maximum water line of the Water Level Indicator Window.
6. To protect against fire, electrical shock and injury to persons, do not immerse cord, plug or the product in water or any liquid.
7. This appliance is not intended to be used by children. Close supervision is necessary when the coffee maker is in use near children.
8. Unplug the coffee maker from outlet when not in use and before cleaning.
9. Allow the coffee maker to cool completely before putting on or removing any parts and before cleaning.
10. Do not operate this appliance when the power cord or plug is damaged, if it malfunctions, or is dropped or has been damaged in any manner. Contact Aroma customer service for examination, repair or electrical/mechanical adjustment.
11. Do not use outdoors.
12. Do not let cord hang over the edge of table and counter.
13. Do not let cord touch hot surfaces.
14. Do not place the coffee maker on or near a gas or electrical burner, or in a heated oven.
15. Do not move or attempt to move the coffee maker while in use or when coffee is hot.
16. Do not use this appliance for other than its intended use.
17. The use of accessory attachments not recommended or supplied by the appliance manufacturer may result in fire, electric shock or injury to persons.

## SAVE THESE INSTRUCTIONS



# IMPORTANT SAFEGUARDS

## Short Cord Instructions

1. A short power-supply cord is provided to reduce the risks resulting from becoming entangled in or tripping over a longer cord.
2. Longer extension cords are available and may be used if care is exercised in their use.
3. If a longer extension cord is used:
  - a. The marked electrical rating of the extension cord should be at least as great as the electrical rating of the appliance.
  - b. The longer cord should be arranged so that it will not drape over the countertop or tabletop where it can be pulled by children or tripped over unintentionally.
  - c. The extension cord should be a grounding-type 3-wire cord.

**DO NOT DRAPE CORD!**



**KEEP AWAY FROM CHILDREN!**

## Grounding Instructions

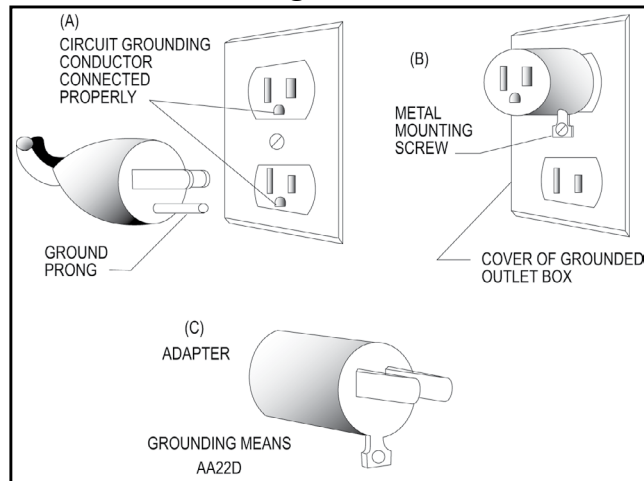

This appliance must be grounded while in use to protect the operator from electrical shock. The appliance is equipped with a 3-conductor cord and a 3-prong grounding-type plug to fit the proper grounding-type receptacle. The appliance has a plug that looks like figure (A). An adapter, figure (B), should be used for connecting figure (A) plugs to two-prong receptacles. The grounding tab, which extends from the adapter, must be connected to a permanent ground such as a properly grounded outlet box as shown in figure (C) using a metal screw.



# PARTS IDENTIFICATION

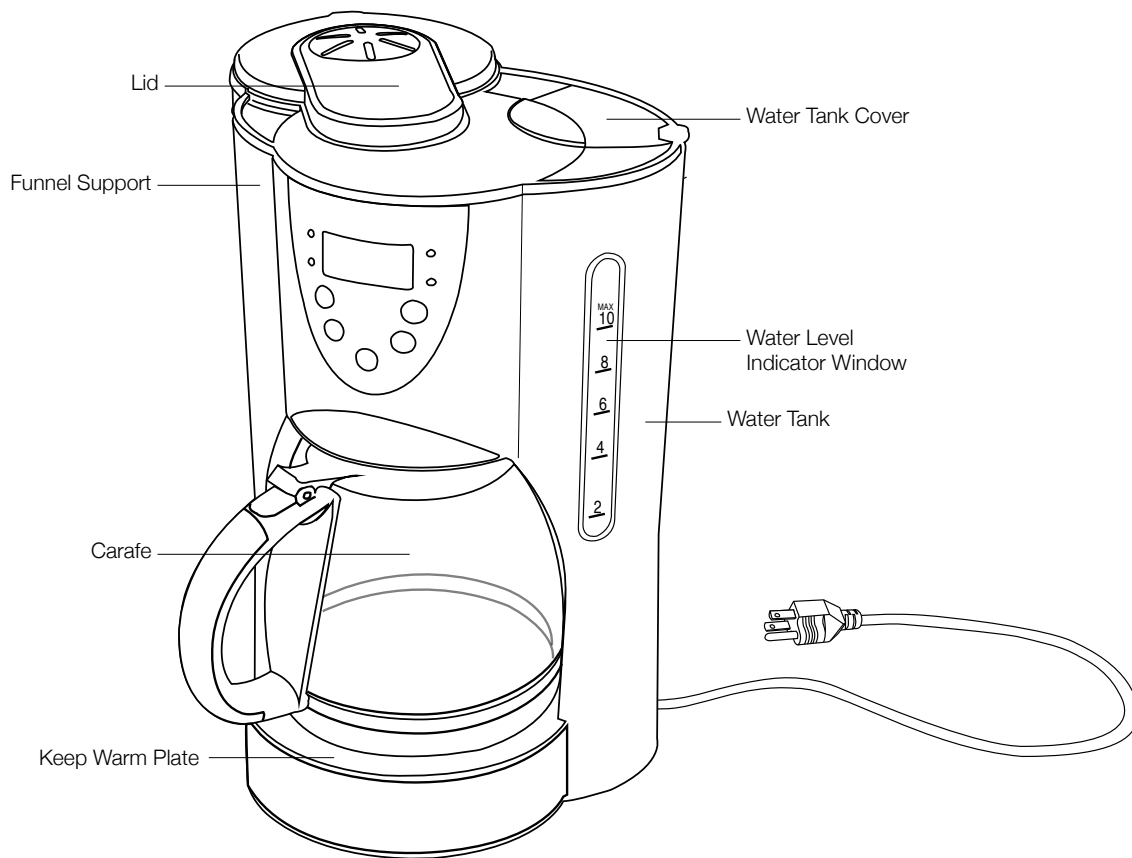



## PARTS IDENTIFICATION (CONT.)

### Digital Display

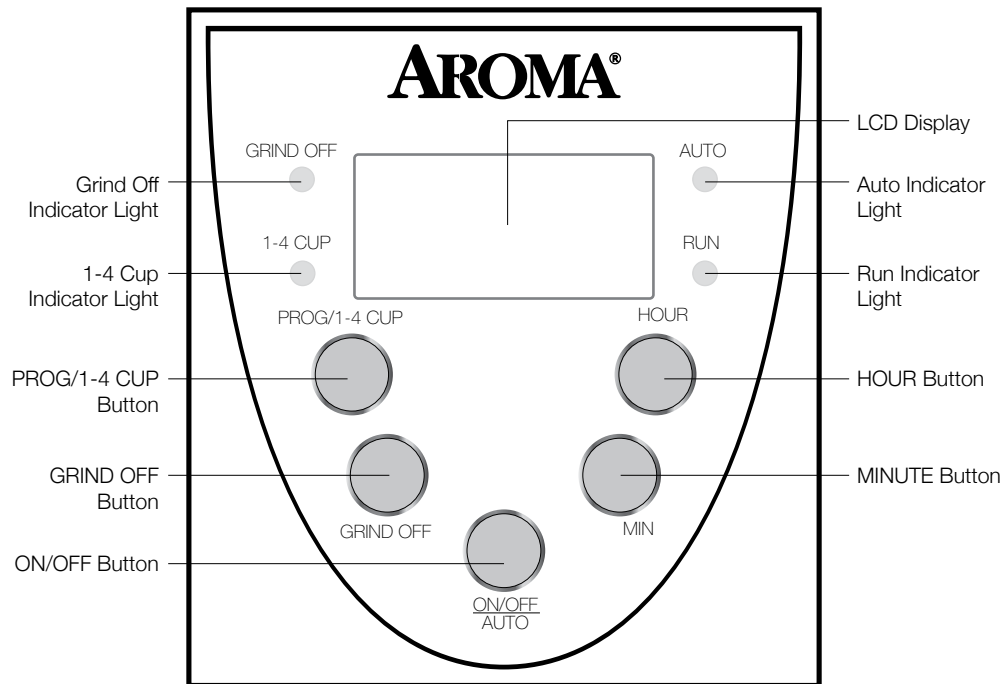

### Filter

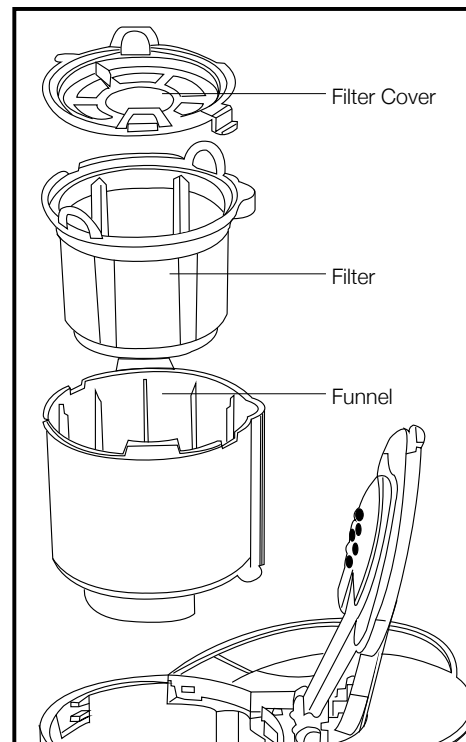



# BEFORE FIRST USE

1. Read all instructions and important safeguards.
2. Remove all packaging material and check that all items have been received in good condition.
3. Tear up all plastic bags as they can pose a risk to children.
4. Make sure the unit is unplugged. Open the top lid, remove the funnel and other detachable parts and clean them in warm, soapy water. Rinse and dry thoroughly.
5. Pour cold drinking water into the water tank to level "10". Do not add coffee. Plug the cord into the power outlet and press the ON/OFF button to have the water filter through the coffee maker and into the Carafe. Repeat 2-3 times to ensure the coffee maker is clean.

## To Set the Clock:

- Set the current time by pressing the PROG/1-4 CUP button once. "CLOCK" will appear on the upper-right corner of the LCD Display. Set to the current time by pressing the HOUR and MINUTE buttons to adjust the hours and minutes accordingly.

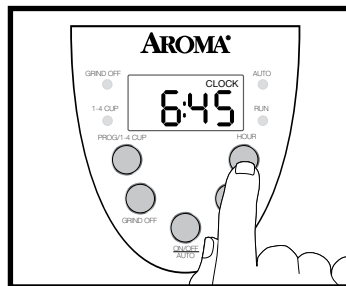
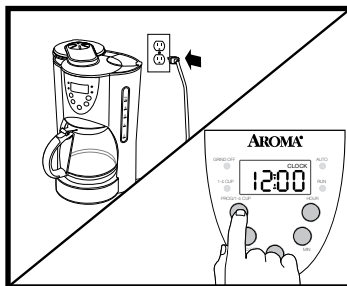



# TO BREW COFFEE WITH COFFEE BEANS

1



Open the Water Tank Cover and pour cold water into the Water Tank until water reaches the desired level of coffee cups indicated on the Water Level Indicator Window.

2

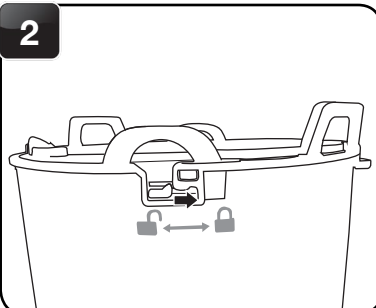

Place the Filter into the Funnel so it rests securely. Once the Filter is set correctly into the Funnel rotate the Filter counterclockwise until an audible click is heard and the Filter is locked into the Funnel.

3

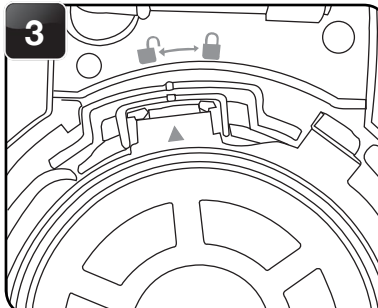

Open the Lid and place the Funnel into the Funnel Support so it rests in place with the ▲ marking on the Filter Cover pointing towards the 🔒 marking.

4

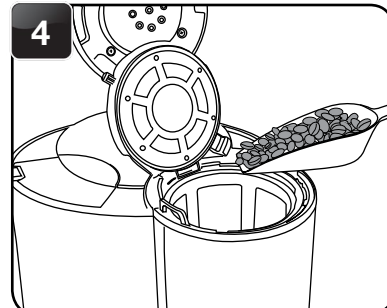

Open the Filter Cover and pour the coffee beans into the Filter and close the Filter Cover. Rotate the Funnel clockwise until the ▲ marking is pointing towards the 🔒 marking. Pull up on the Funnel to make sure it is locked securely into the Funnel Support and pull up on the Filter Lid to make sure it is locked securely to the Filter.

5

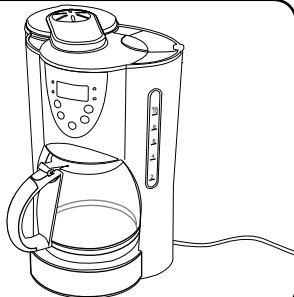

Close the Lid. Make sure the Carafe is placed securely on the Keep-Warm Plate.



NOTE

- Usually one cup of coffee requires about 2-3 tablespoons of coffee beans.
- Never pour hot water, milk, coffee powder or any other liquids besides cold water into the Water Tank.
- As a safety measure, if the Funnel or Lid is not secured in place the coffee maker will not work and a blinking "OP1" or "OP2" will be displayed on the LCD Display with a beeping sound.
- The brewed coffee amount will be a little less than the water amount originally added since some water is absorbed by the coffee grounds.





## TO BREW COFFEE WITH COFFEE BEANS

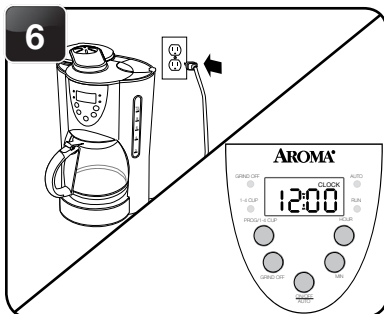

Plug the power cord into the outlet. The display will show a "12:00" with the colon blinking.

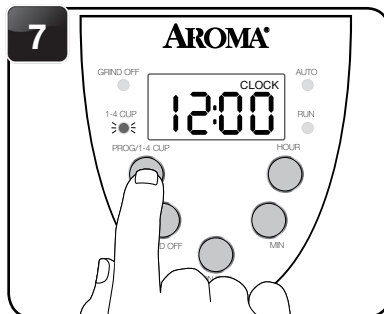

If brewing only 1-4 cups of coffee, press and hold the PROG/1-4 CUP button until the 1-4 Cup indicator light illuminates. Otherwise the coffee maker automatically sets to brewing 5-12 cups.

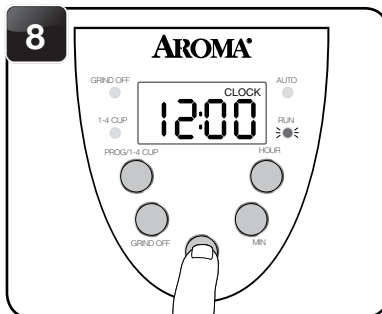

Press the ON/OFF button. The Run indicator light will illuminate and the coffee maker will start grinding the coffee beans. Once the beans are ground the brewing process will begin automatically.

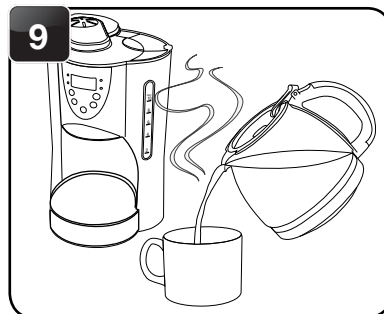

Make sure the coffee maker is finished brewing. Once finished, remove the Carafe for serving.



When finished brewing the Keep-Warm Plate will keep the Carafe warm for 2 hours.



NOTE

- If 1-4 cups worth of water is added to the Water Tank and the PROG/1-4 CUP button is not selected the coffee maker will still only brew 1-4 cups. The Prog/1-4 Cup function is designed to maximize the quality of the coffee when smaller amounts are brewed.
- If you want to cancel grinding at any time, press the GRIND OFF button. The Grind Off indicator light will illuminate and the appliance will start brewing.
- The brewing process can be interrupted by pressing the ON/OFF button twice at any time. The appliance will resume brewing once the ON/OFF button is pressed again.
- You can remove the Carafe to pour and serve brewed coffee at any time during the brewing cycle. The appliance will stop dripping automatically once the Carafe is removed. **DO NOT** remove the Carafe for more than 30 seconds as the coffee maker will eventually begin dripping coffee again. If serving with the Carafe for longer than 30 seconds, turn the coffee maker off by pressing the ON/OFF button twice.



CAUTION

- Brewed coffee will be hot. Always use caution when handling the Carafe.



# TO BREW COFFEE WITH COFFEE GROUNDS

*Follow steps 1 to 3 of “To Brew Coffee With Coffee Beans” beginning on page 6.*

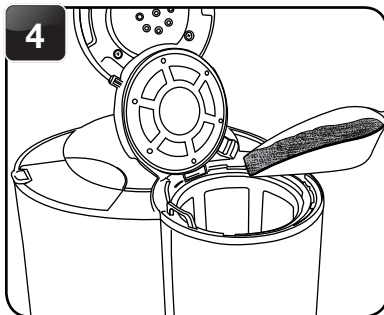

**4** Open the Filter Cover and pour the coffee grounds into the Filter and close the Filter Cover. Rotate the Funnel clockwise until the ▲ marking is pointing towards the 🔒 marking. Pull up on the Funnel to make sure it is locked securely into the Funnel Support and pull up on the Filter Lid to make sure it is locked securely to the Filter.



**5** Close the Lid. Make sure the Carafe is placed securely on the Keep-Warm Plate.

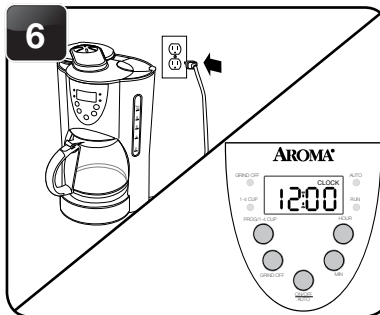

**6** Plug the power cord into the outlet. The display will show a “12:00” with the colon blinking.

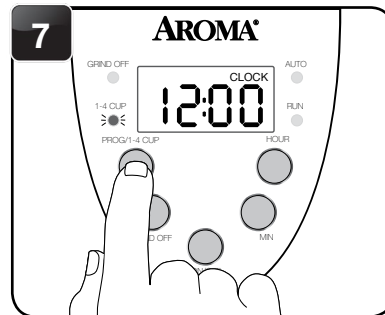

**7** If brewing only 1-4 cups of coffee, press and hold the PROG/1-4 CUP button until the 1-4 Cup indicator light illuminates. Otherwise the coffee maker automatically sets to brewing 5-12 cups.



**NOTE**

- Usually one cup of coffee requires about 2-3 tablespoons of coffee grounds.
- Never pour hot water, milk, coffee powder or any other liquids besides cold water into the Water Tank.
- As a safety measure, if the Funnel or Lid is not secured in place the coffee maker will not work and a blinking “OP1” or “OP2” will be displayed on the LCD Display with a beeping sound.
- If 1-4 cups worth of water is added to the Water Tank and the PROG/1-4 CUP button is not selected the coffee maker will still only brew 1-4 cups. The Prog./1-4 Cup function is designed to maximize the quality of the coffee when smaller amounts are brewed.



## TO BREW COFFEE WITH COFFEE GROUNDS

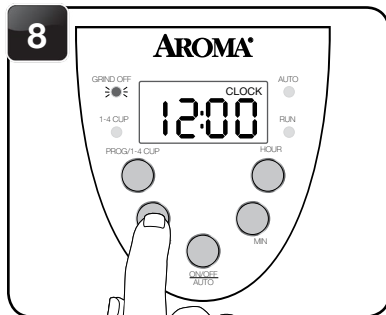

Press the **GRIND OFF** button and the **Grind Off** indicator light will illuminate.

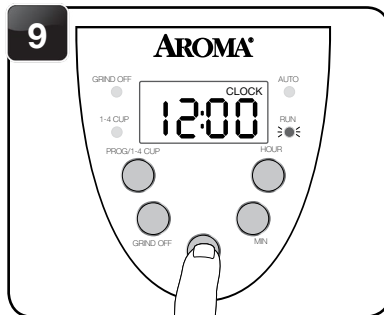

Press the **ON/OFF** button. The **Run** indicator light will illuminate and the coffee maker will start brewing the coffee.

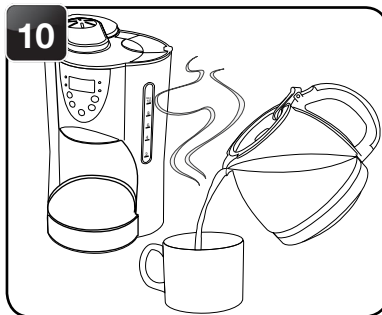

Make sure the coffee maker is finished brewing. Once finished, remove the Carafe for serving.



When finished brewing the **Keep-Warm Plate** will keep the Carafe warm for 2 hours.



NOTE

- The brewing process can be interrupted by pressing the **ON/OFF** button twice at any time. The appliance will resume brewing once the **ON/OFF** button is pressed again.
- You can remove the Carafe to pour and serve brewed coffee at any time during the brewing cycle. The appliance will stop dripping automatically once the Carafe is removed. **DO NOT** remove the Carafe for more than 30 seconds as the coffee maker will eventually begin dripping coffee again. If serving with the Carafe for longer than 30 seconds, turn the coffee maker off by pressing the **ON/OFF** button twice.
- The brewed coffee amount will be a little less than the water amount originally added since some water is absorbed by the coffee grounds.



CAUTION

- Brewed coffee will be hot. Always use caution when handling the Carafe.



# TO USE THE DELAY START FUNCTION

*Follow steps 1 to 7 on page 6, or steps 1 to 8 on page 8. Depending on if using grounds or beans.*

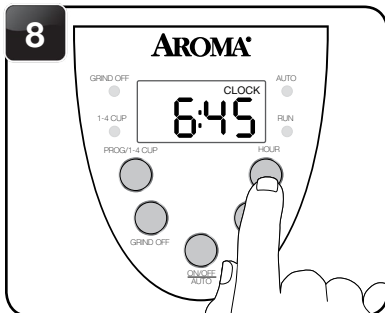

Set the current time by pressing the PROG/1-4 CUP button once. "CLOCK" will appear on the upper-right corner of the LCD Display. Set to the current time by pressing the HOUR and MINUTE buttons to adjust the hours and minutes accordingly.

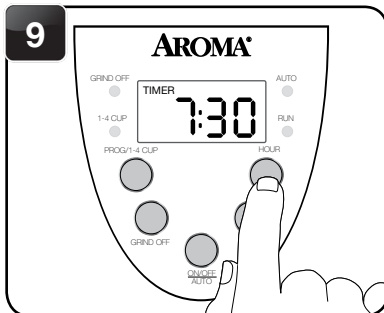

Press the PROG/1-4 CUP button again after the current time has been set. "TIMER" will show on the upper-left corner of the LCD Display. Set to the desired start time by pressing the HOUR and MINUTE buttons to adjust the hours and minutes accordingly. Press the PROG/1-4 CUP button again to have the LCD Display show the current time.

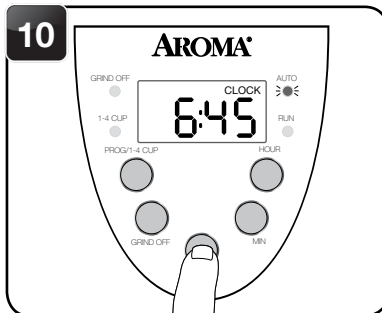

Press the ON/OFF button twice. The Auto indicator light will illuminate and the LCD display will show the current time.

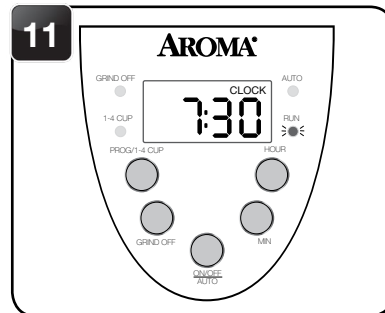

Once the clock reaches the programmed start time, the Auto indicator light will turn off and the Run indicator light will illuminate. The coffee maker will start to grind and brew or just brew coffee depending on if the Grind Off indicator light is illuminated.



NOTE

- The clock and timer can be set from 0:00 to 24:00 hours.
- The brewing process can be interrupted by pressing the ON/OFF button at any time. The appliance will resume brewing once the ON/OFF button is pressed again.
- You can remove the Carafe to pour and serve brewed coffee at any time during the brewing cycle. The appliance will stop dripping automatically once the Carafe is removed. **DO NOT** remove the Carafe for more than 30 seconds as the coffee maker will eventually begin dripping coffee again. If serving with the Carafe for longer than 30 seconds, turn the coffee maker off by pressing the ON/OFF button twice.
- The brewed coffee amount will be a little less than the water amount originally added since some water is absorbed by the coffee grounds.



## TO USE THE DELAY START FUNCTION

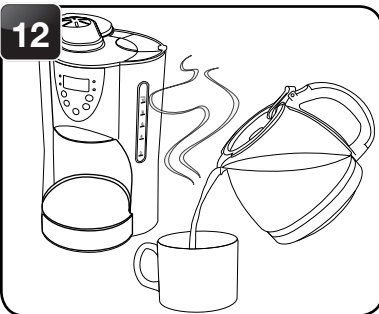

**12** Make sure the coffee maker is finished brewing. Once finished, remove the Carafe for serving.

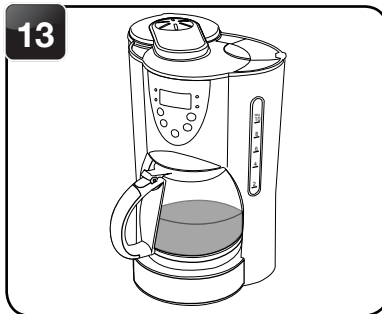

**13** When finished brewing the Keep-Warm Plate will keep the Carafe warm for 2 hours.



### NOTE

- If a pre-programmed time has been set for the coffee maker and the Auto indicator light is illuminated, the coffee maker can still be used at any time. To operate, press the ON/OFF button to switch off the appliance from its Delay Start function. Then operate the coffee maker as normal following the steps on **page 6** or **page 8**.



### CAUTION

- Brewed coffee will be hot. Always use caution when handling the Carafe.



# TO CLEAN

*The coffee maker will become hot during and immediately after the brewing process. Allow time for it to cool completely before disassembly or cleaning.*

1

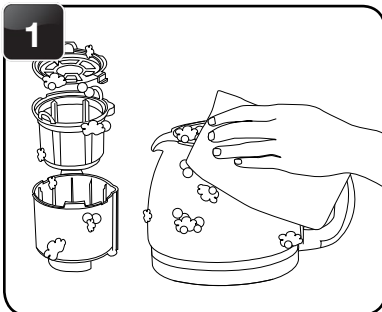

**Clean all removable parts and the Carafe in warm, soapy water.**

2



**Wipe the coffee maker's exterior surface with a soft, damp cloth to remove stains.**

3

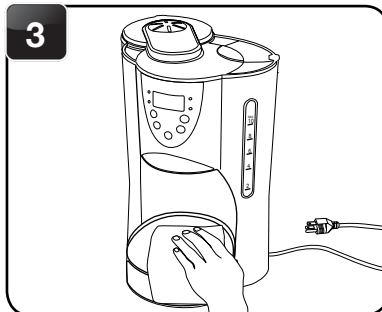

**Use a damp cloth to gently wipe the Keep-Warm Plate. Do not use abrasive cleaners.**

4



**Dry all parts thoroughly. Attach all removable parts and store in a cool, dry place.**



**CAUTION**

- Be sure to unplug the appliance before cleaning. To protect against electrical shock, do not immerse cord, plug or the coffee maker base in water or liquid.



**HELPFUL  
HINT**

- All removable parts are dishwasher safe.



# REMOVING MINERAL DEPOSITS

To keep your coffee maker operating efficiently, it's recommended to regularly clean mineral deposits left from water by following these steps:

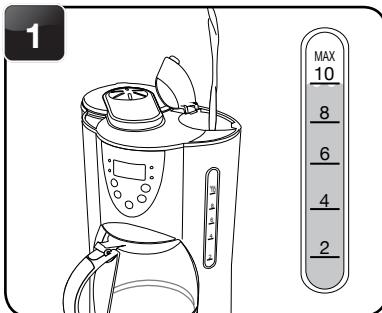

**1** Fill the Water Tank with water and household descaler to the level "10" marking on the Water Level Indicator Window (use a ratio of water to descaler of 4 to 1). Make sure the Carafe is placed securely on the Keep-Warm Plate.

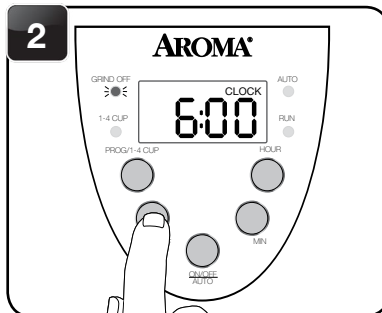

**2** Press the GRIND OFF button. The Grind Off indicator light will illuminate.

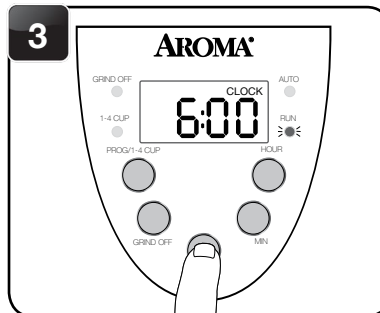

**3** Press the ON/OFF button once. The Run indicator light will illuminate and the coffee maker will begin its brewing cycle.

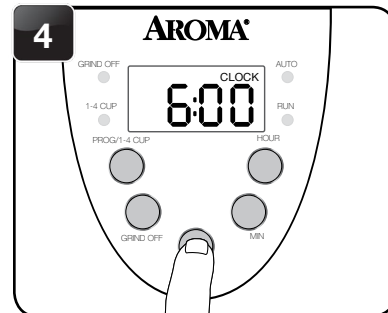

**4** After the equivalent of 1 cup of water and descaler solution has dripped into the Carafe press the ON/OFF button twice to stop the cycling.



- Cycled water and descaler solution will be hot. Always use caution when handling the Carafe.



## REMOVING MINERAL DEPOSITS

5

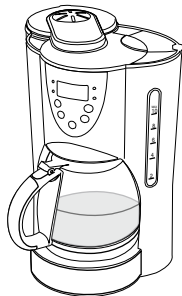

Leave the coffee maker with the water and descaler solution inside for 15 minutes. Repeat steps 3-4 and leave again for 15 minutes.

6

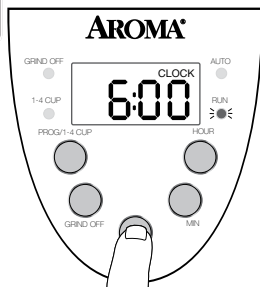

Press the ON/OFF button once and run the cycle until the Water Tank is completely empty.

7

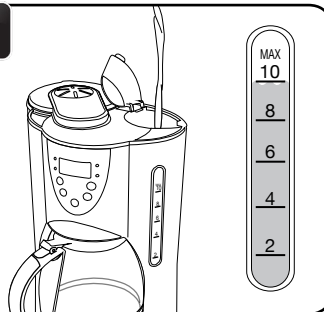

Empty the Carafe of the water and descaler solution and place on the Keep-Warm Plate. Fill the Water Tank with water up to the level "10" marking on the Water Level Indicator Window. Press the ON/OFF button to let the coffee maker run a full cycle. Once complete, do this at least two more times to complete rinsing.





# TIPS TO BREW GREAT-TASTING COFFEE

1. A clean coffee maker is essential for making great-tasting coffee. Clean the coffee maker regularly as outlined in the “TO CLEAN” and the “REMOVING MINERAL DEPOSITS” sections beginning on **pages 12 and 13**. Always use fresh, cold water in the coffee maker.
2. Store unused coffee grounds in a cool, dry place. After opening a package of coffee grounds, reseal it tightly and store it in a refrigerator to maintain its freshness.
3. For optimum coffee taste, buy whole coffee beans and finely grind them just before brewing.
4. Do not re-use coffee grounds since this will greatly reduce coffee flavor. Reheating coffee is not recommended as coffee is at its peak flavor immediately after brewing.
5. Clean the coffee maker when over-extraction causes oiliness. Small oil droplets on the surface of brewed, black coffee are due to the extraction of oil from the coffee grounds.
6. Oiliness may occur more frequently in brewed coffee, if heavily roasted beans or grounds are used.



# WARRANTY

## LIMITED WARRANTY

Aroma Housewares Company warrants this product free from defects in material and workmanship for one year from provable date of purchase in the United States.

Within this warranty period, Aroma Housewares Company will repair or replace, at its option, defective parts at no charge, provided the product is returned, freight prepaid with proof of purchase and U.S. \$22.00 for shipping and handling charges payable to Aroma Housewares Company. Before returning an item, please call the toll free number below for a return authorization number. Allow 2-4 weeks for return shipping.

This warranty does not cover improper installation, misuse, abuse or neglect on the part of the owner. Warranty is also invalid in any case that the product is taken apart or serviced by an unauthorized service station.

This warranty gives you specific legal rights, which may vary from state to state, and does not cover areas outside the United States.

AROMA HOUSEWARES COMPANY  
6469 Flanders Drive  
San Diego, California 92121  
1-800-276-6286  
M-F, 8:30 AM - 4:30 PM, Pacific Time  
Website: [www.AromaCo.com](http://www.AromaCo.com)

## SERVICE & SUPPORT

In the event of a warranty claim, or if service is required for this product, please contact Aroma® customer service toll-free at:

1-800-276-6286  
M-F, 8:30AM-4:30PM, Pacific Time

Or we can be reached online at [CustomerService@AromaCo.com](mailto:CustomerService@AromaCo.com).

For your records, we recommend stapling your sales receipt to this page along with a written record of the following:

Date of Purchase: \_\_\_\_\_

Place of Purchase: \_\_\_\_\_



### NOTE

- Proof of purchase is required for all warranty claims.



# NOTES

---

---

---

---

---

---

---

---

---

---

---